

## ❖ SW-4000M-PMCL

## ❖ SW-8000M-PMCL

CMOS Monochrome Line Scan Cameras

- 4096 pixels
- 8192 pixels
- 200 kHz
- 100 kHz

Sweep Series



- **Monochrome CMOS Line Scan Camera**
- **Resolution:** 4096 pixels in a line (SW-4000M-PMCL)  
8192 pixels in a line (SW-8000M-PMCL)
- **Scan rate:** 200,000 lines per second - 200 kHz (SW-4000M-PMCL)  
100,000 lines per second - 100 kHz (SW-8000M-PMCL)
- **Sensor scanning width:** 30.72 mm
- **Video signal output:** 8-bit or 10-bit via Mini Camera Link
- **Interface:** Power over Mini Camera Link
- **JAI SDK and GenICam compliant**
- **F-mount and M-42x1 mount**

# Specifications for Sweep SW-4000M-PMCL and SW-8000M-PMCL

Specifications			
Scanning system	CMOS line scan sensor		
Sensors type	JAI custom made sensor (APS-C)		
Sensor resolution (effective pixels)	<b>SW-4000M:</b> 4096 pixels horizontal <b>SW-8000M:</b> 8192 pixels horizontal		
Scan rate (max)	<b>SW-4000M:</b> 200 kHz (Full Camera Link 8-bit config.) <b>SW-8000M:</b> 100 kHz (Full Camera Link 8-bit config.)		
Sensor scanning width	<b>SW-4000M:</b> 30.72 mm (Mode-A, Small well) 30.72 mm (Mode-B, Large well) <b>SW-8000M:</b> 30.72 mm		
Cell size	<b>SW-4000M:</b> 7.5 um (H) x 7.5 um (V) (Mode-A, Small well) 7.5 um (H) x 10.5 um (V) (Mode-B, Large well) <b>SW-8000M:</b> 3.75 um (H) x 5.78 um (V)		
Responsivity	<b>SW-4000M:</b> 58 DN/(n)/cm <sup>2</sup> (Mode-A, Small well) (@10bits, gain= 1x, λ = 650nm)  53 DN/(n)/cm <sup>2</sup> (Mode-B, Large well) (@10bits, gain= 1x, λ = 650nm) <b>SW-8000M:</b> 23 DN/(n)/cm <sup>2</sup> (@10bits, gain= 1x, λ = 650nm)		
S/N ratio	60 dB @10bit (Typical)		
Pixel clock	31.875 to 85MHz adjustable		
Video signal output	8-bit or 10-bit via Mini Camera Link connector		
Inputs/Outputs	GPIO in/out via 12-pin connector		
Trigger mode	Line start		
Exposure mode (Exposure time)	Off: Line period ~3.08μs Timed: 4μs to 15.148ms Trigger Width: 4μs~		
Shading correction	Flat shading		
Gain	Manual/Auto (Digital All: odB ~ +24dB (x1~x16) 1-Step = x0.01)		
Gamma	9 Step 1.0 ~ 0.45		
LUT	256 point		
Auto Level Control (ALC)	Exposure time (Exposure auto): 4μs~15 Digital All (Gain auto): odB ~ +24dB(x1~x16) 1STEP = x0.01		
Interface	Power over Mini Camera Link NB: Running Power over Camera Link requires 2 cables		
Operating temperature	-5°C to +45°C		
Storage temperature	-25°C to +60°C		
Humidity	20 - 80% non-condensing		
Vibration	10G (20 Hz to 200 Hz XYZ direction)		
Shock	80G		
Regulations	CE (EN 61000-6-2, EN 61000-6-3), FCC part 15 class B		
Power and power consumption	PoCL or 12pin (12V to 24V DC ± 10%). 435 mA/ 5.22W max. (full frame @ 12V) NB: Running Power over Camera Link requires 2 lines		
Lens mounts	Mount type:	<b>F-Mount</b> Bayonet	<b>M-42x1 mount</b> Metric screw thread
	Diameter:	44 mm	42 mm
	Flange Back Distance:	46.5 mm	16 mm
Dimensions (H x W x L)	62 x 62 x 53 mm (w/o projection part)		
Weight	320 g		

## Ordering Information

**SW-4000M-PMCL** CMOS Monochrome Line Scan Camera (4096 pixels)  
**SW-8000M-PMCL** CMOS Monochrome Line Scan Camera (8192 pixels)

## Dimensions

### F-mount

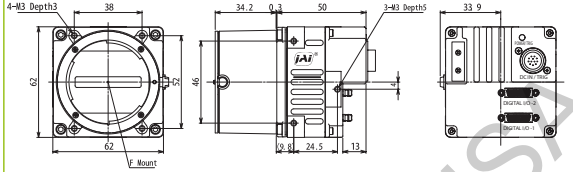

### M-42x1 mount

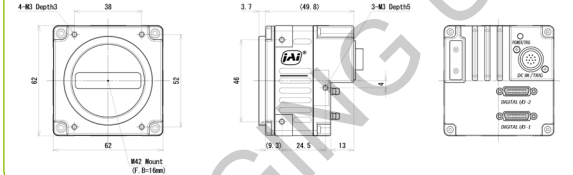

## Connector pin-out

### DC In / Trigger

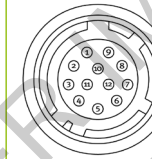

12-pin connector

Mini-CL interface

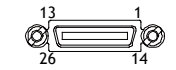

Pin no.	Attribute	Signal	Remarks
1		GND	
2	Power In	DC(+12V) in	DC12V±4 V±10%
3		GND	
4		RESERVED	
5		GND	
6	I	RxD in	
7	O	TxD out	
8		GND	
9	O	TTL Out	
10	I	TTL In	
11	POo	DC(+12V) in	DC12V±4 V±10%
12		GND	

Pin no.	In/Out	Name	Note
1,4		Power	DC in
2(-),15(+)	O	TxDOUTo	Data output
3(-),16(+)	O	TxDOUT1	
4(-),17(+)	O	TxDOUT2	
5(-),18(+)	O	TxDOUT3	CL Clock
6(-),19(+)	O	TxDOUT3	Data output
7(+),20(-)	I	SerTC (RxD)	LVDS serial control (CC1 only)
8(-),21(+)	O	SerTIG (TxD)	LVDS serial control (CC1 only)
9(-),22(+)	I	CCs (Trigger)	Trigger input (CC1 only)
10(+),23(-)	I	CCs (Reserved)	(CC1 only)
11,24		NC	
12,25		NC	
13,26		Shield	GND

## Spectral Response

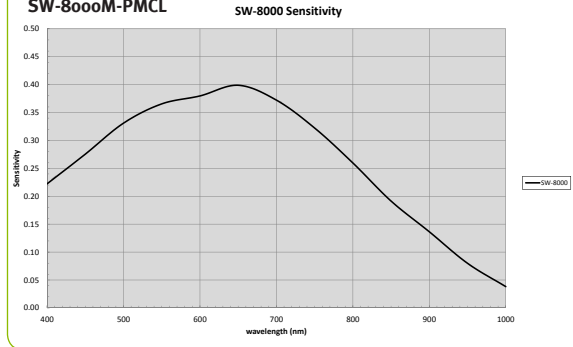
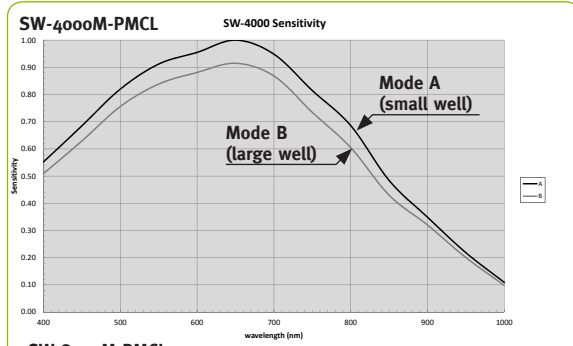

Spectral response without lens

**Europe, Middle East & Africa**  
Phone +45 4457 8888  
Fax +45 4491 8880

**Asia Pacific**  
Phone +81 45 440 0154  
Fax +81 45 440 0166

**Americas**  
Phone (Toll-Free) 1 800 445 5444  
Phone +1 408 383 0300



Visit our web site on [www.jai.com](http://www.jai.com)

Company and product names mentioned in this datasheet are trademarks or registered trademarks of their respective owners. JAI AS cannot be held responsible for any technical or typographical errors and reserves the right to make changes to products and documentation without prior notification. JUNE 2016 V2